

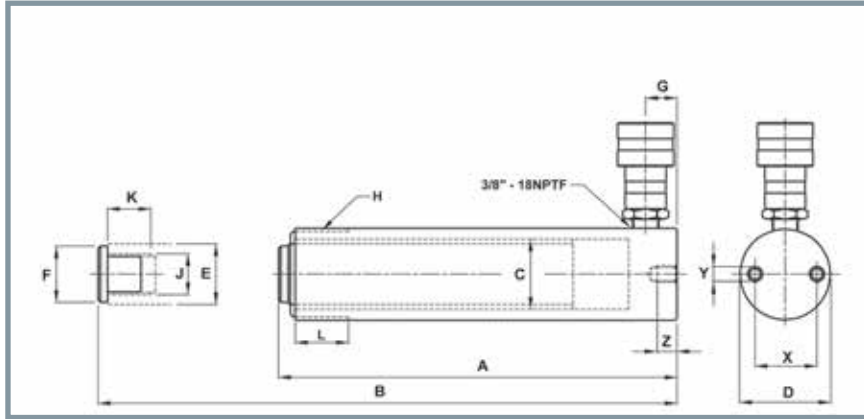

## SINGLE ACTING CYLINDERS



6C30T08

### CYLINDER DIMENSIONS

Cylinder Capacity (tons)	Stroke (in)	Product Code	Cylinder Effective Area (in <sup>2</sup> )	Pressure at Capacity (psi)	Oil Capacity (in <sup>3</sup> )	Collapsed Height	Extended Height	Cylinder Bore Dia. (in)	Outside Dia. (in)	Plunger Dia. (in)	Saddle Dia. (in)	
						A (in)	B (in)					
15	0.99	6C15T01	3.14	9,550	3.11	4.88	5.87	2.00	2.75	1.63	1.50	
	2.01	6C15T02			6.31	5.87	7.88					
	3.98	6C15T04			12.50	7.87	11.85					
	5.87	6C15T06			18.43	10.67	16.54					
	7.87	6C15T08			24.71	12.68	20.55					
	9.88	6C15T10			31.02	14.69	24.57					
	12.01	6C15T12			37.71	16.65	28.66					
	14.02	6C15T14			44.02	18.66	32.68					
25	1.02	6C25T01	5.14	9,730	5.24	5.84	6.86	2.56	3.35	2.24	1.97	
	2.01	6C25T02			10.33	6.82	8.83					
	3.94	6C25T04			20.25	8.78	12.72					
	5.94	6C25T06			30.53	10.79	16.73					
	7.95	6C25T08			40.86	12.80	20.75					
	9.96	6C25T10			51.19	14.80	24.76					
	12.24	6C25T12			62.91	16.73	28.97					
	14.25	6C25T14			73.25	18.74	32.99					
30	8.27	6C30T08	6.49	9,240	53.67	15.24	23.51	2.87	4.00	2.24	2.13	
55	2.01	6C55T02	10.99	10,000	22.09	6.93	8.94	3.74	5.00	3.15	2.76	
	3.98	6C55T04			43.74	8.94	12.92					
	6.22	6C55T06			68.36	11.14	17.36					
	13.27	6C55T13			145.84	18.15	31.42					
75	6.14	6C75T06	16.10	9,320	98.85	11.22	17.36	4.53	5.79	3.74	2.76	
	13.11	6C75T13			211.07	19.37	32.48					
100	6.61	6C100T06	20.57	9,720	135.97	14.06	20.67	5.12	6.97	4.13	2.76	
	10.24	6C100T10			210.64	17.68	27.92					

