



SERVICE PARTS LIST

BULLETIN NO.
54-16-4090

SPECIFY CATALOG NO. AND SERIAL NO. WHEN ORDERING PARTS		REVISED BULLETIN	DATE
DYMODRILL with CLUTCH			Nov.'92
CATALOG NO. 4096	STARTING SERIAL NO. 798-1001	WIRING INSTRUCTION 58-01-0930	

EXAMPLE:

Component Parts (Small #) Are Included When Ordering The Assembly (Large #).

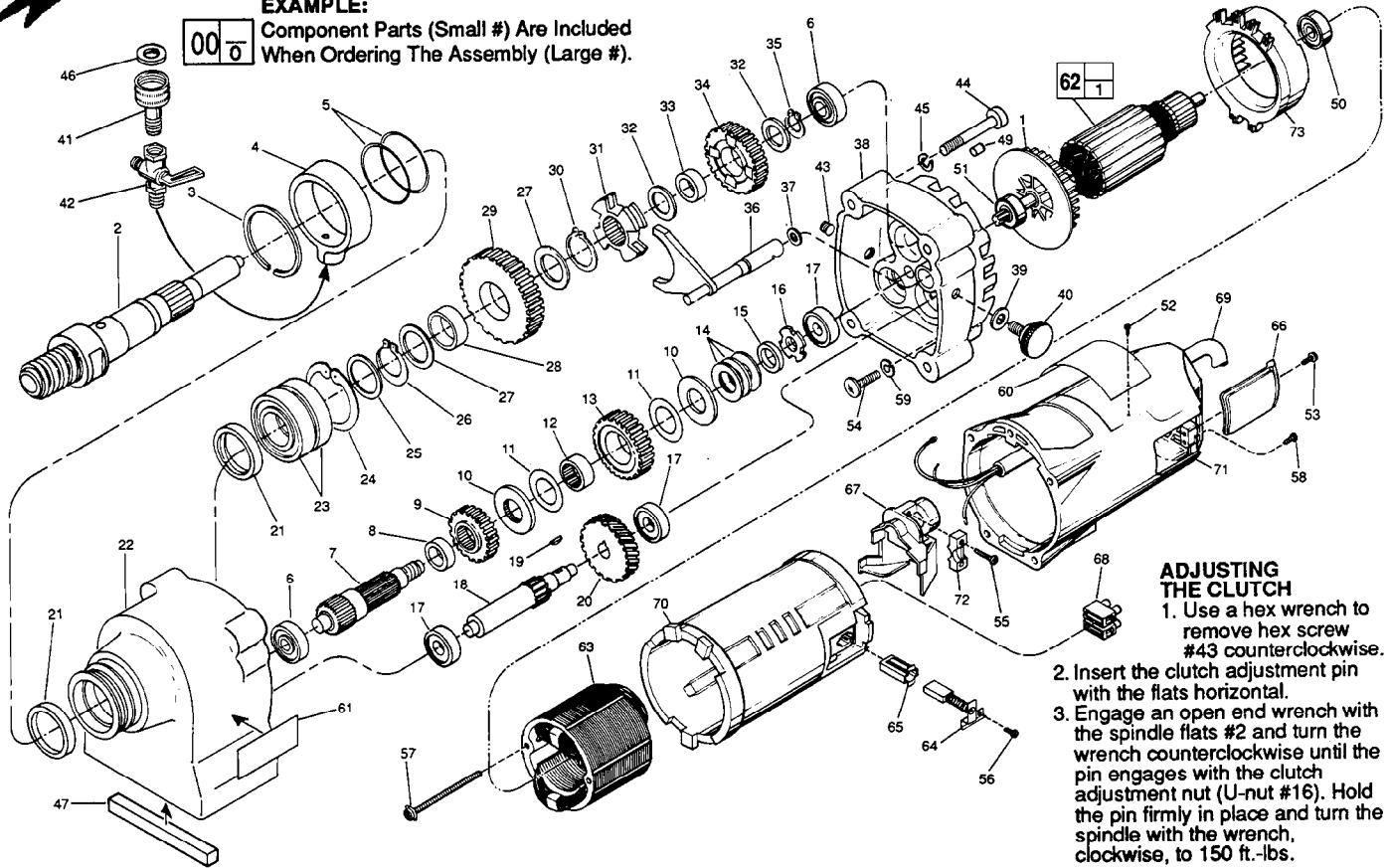

ADJUSTING THE CLUTCH

1. Use a hex wrench to remove hex screw #43 counterclockwise.
2. Insert the clutch adjustment pin with the flats horizontal.
3. Engage an open end wrench with the spindle flats #2 and turn the wrench counterclockwise until the pin engages with the clutch adjustment nut (U-nut #16). Hold the pin firmly in place and turn the spindle with the wrench, clockwise, to 150 ft.-lbs.

FIG.	PART NO.	DESCRIPTION OF PART	NO. REQ.	FIG.	PART NO.	DESCRIPTION OF PART	NO. REQ.
1	22-84-0790	Fan	(1)	43	06-83-1350	Hex Screw	(1)
2	38-50-5890	Main Shaft	(1)	44	05-74-0450	Hex Hd. Cap Screw	(4)
3	34-60-3560	Retaining Ring	(1)	45	05-90-0180	Lock Washer	(4)
4	28-20-1315	Feed Water Cover	(1)	46	45-88-0800	Water Hose Washer	(1)
5	34-40-4260	O-Ring	(2)	47	43-96-0170	Key	(1)
6	02-04-5100	Ball Bearing	(2)	49	45-30-0190	Retaining Slug	(1)
7	36-14-0740	Clutch Shaft	(1)	50	02-04-1041	Ball Bearing	(1)
8	45-36-1485	Spacer	(1)	51	02-04-1229	Ball Bearing	(1)
9	32-10-4070	Clutch Gear	(1)	52	06-85-0200	Nameplate Screw	(2)
10	43-06-0630	Pressure Disc	(2)	53	06-82-5316	8-32 x 1/2" Pan Hd. Slit. Tapt. T-20	(2)
11	43-06-0640	Friction Disc	(1)	54	06-82-5514	1/4-20 x 1-1/2" Pan Slit. Tapt. T-30	(4)
12	42-24-0530	Bearing	(1)	55	06-82-7326	8-16 x 1" Pan Hd. Slit. Plast. T-20	(2)
13	32-44-1370	2nd Intermediate Gear	(1)	56	06-82-8835	8-32 x 5/16" Pan Hd. Sems T-20	(2)
14	40-50-8530	Spring Washer	(3)	57	06-82-9152	10-24 x 2-3/4" Pan Hd. Sems T-25	(2)
15	45-36-1480	Spacer	(1)	58	06-95-5200	8-32 x 5/16" Slit. Hex Hd. Screw	(1)
16	05-59-2010	U-Nut	(1)	59	06-97-4000	1/4" Split Ring Lockwasher	(4)
17	02-04-5090	Ball Bearing	(3)	60	12-15-7020	Nameplate	(1)
18	36-66-3220	2nd Pinion	(1)	61	12-98-7280	Shift Label	(1)
19	06-42-3770	Woodruff Key	(1)	62	18-70-0320	120 V Armature	(1)
20	32-40-2240	Intermediate Gear	(1)	63	18-70-0290	120 V Field	(1)
21	45-06-0580	Seal	(2)	64	22-18-0702	Brush Assembly	(2)
22	28-14-2240	Gear Case	(1)	65	22-20-0680	Brush Tube	(2)
23	14-30-0730	Gear Case Assembly	(1)	66	22-32-0350	Brush Cover	(2)
24	02-04-5080	Ball Bearing	(2)	67	22-38-0140	Wire Trap	(1)
25	34-80-5040	Retaining Ring	(1)	68	22-56-0470	Terminal Block	(1)
26	45-88-8390	Washer	(1)	69	22-64-4460	Cord Set	(1)
27	34-60-3550	Retaining Ring	(1)	70	23-16-1410	Motor Insulator	(1)
28	45-88-8370	Washer	(2)	71	28-50-6363	Motor Housing	(1)
29	42-24-0540	Bearing	(1)	72	31-17-0200	Cord Clamp	(1)
30	32-75-3380	Final Gear-Low	(1)	73	42-14-0291	Baffle	(1)
31	34-60-3540	Retaining Ring	(1)		44-60-1320	Clutch Adjustment Pin	(1)
32	42-76-0520	Shift Collar	(1)		49-96-0085	3/16" Hex Key	(1)
33	45-88-8380	Washer	(2)		49-96-4700	1-3/8" Open End Wrench	(1)
34	42-24-0550	Bearing	(1)				
35	32-75-3390	Final Gear-High	(1)				
36	34-60-3530	Retaining Ring	(1)				
37	44-10-0320	Shift Lever	(1)				
38	34-40-4250	O-Ring	(1)				
39	28-28-2040	Diaphragm	(1)				
40	45-88-8395	Rubber Washer	(1)				
41	43-98-0380	Speed Change Knob	(1)				
42	42-04-0600	Water Hose Adapter	(1)				
	45-80-0060	Shutoff Valve	(1)				

FOR MOUNTING DRILL MOTOR USE:
 06-75-3090 1/4-20 x 7/8" Socket Hd. Screw (4)
 06-97-3800 #14 Split Ring Lockwasher (4)

MILWAUKEE ELECTRIC TOOL CORPORATION
 13135 W. LISBON RD., BROOKFIELD, WI 53005