

# Specialty all-steel clamps:

## Hold down clamps



Simply better.

## Hold down clamps

The BESSEY® table clamp offering has a variety of options available for challenging table clamping on a T-Slot table.

The BSG clamp has a traditional bar clamp configuration while the BSN family of clamps have a lever handle with a ratcheting mechanism for controlled, fast and vibration proof clamping. Ideal for machines equipped with "T" slots.

A cantilevered option keeps the handle behind the clamp's rail for minimal obstruction to the tool head while the BESSEY® FC24-8 clamp may be used in a variety of ways to accommodate your needs while clamping.

Some great choices for challenging work applications



### Hold down table clamp

Vibration proof, ratchet action for rapid clamping. Pressure pad self-adjusts on the workpiece. Drop forged steel clamping arm. Mounting hole accepts 5/8" bolts.

	Max Clamping Height	Throat Depth	Clamping Force	Rail Profile	Fixing Hole	Approx. Weight
<b>BS3N</b>	8"	4.75"	1200 lbs	0.87" x 0.41"	0.51"	3.42 lbs
<b>BS4N</b>	8"	4.75"	1650 lbs	1.10" x 0.43"	0.65"	5.84 lbs
<b>2400 HD-10</b>	9.5"	5.5"	2220 lbs	1.18" x 0.59"	0.65"	7.80 lbs
<b>BS6N</b>	20"	5.5"	2220 lbs	1.18" x 0.59"	0.65"	8.82 lbs



### Claw machine clamp, MCL

A cantilever jaw for clamping in tight spaces with the screw positioned outside of work area. Use for drilling and light milling work. Full rotation outside of the work area. Mounting hole accepts 5/8" bolts.

	Max Clamping Height	Throat Depth	Clamping Force	Rail Profile	Fixing Hole	Approx. Weight
<b>MCL8</b>	8"	4.84" - 5.5"	1450 lbs	1.10" x 0.43"	0.65"	6.74 lbs



# Specialty all-steel clamps:

## Hold down clamps



Simply better.

### Hold down table clamps, BSG

For fastening to tables and other equipment. Long life due to heat-resistant pressure plate with sintered steel insert, which can be tilted up to 35°. Mounting hole accepts 5/8" bolts.

	Max Clamping Height	Throat Depth	Clamping Force	Rail Profile	Fixing Hole	Approx. Weight
<b>BSG21-14</b>	8.25"	5.5"	2650 lbs	1.18" x 0.59"	0.65"	7.10 lbs



### Jig & fixture, FC

A full rotation of 360° for easy work-piece removal. The pressure plate swivels up to 35° and the bushing O/D is 1 13/16", and can fit a table thickness of 1/2" to 1 1/2". Bushing can be set to be freely rotating, fixed or quick release position by adjusting or removing bottom plate.

	Clamping Capacity	Throat Depth	Clamping Force	Approx. Weight
<b>FC24-8</b>	8"	5 1/2"	2660 lbs	6.45 lbs
<b>3100459</b>	Inner/outer bushing set for FC24			



### RiteHite Long Reach, Model L and Model S

Holds workpiece in place with the simple, self-positioning, single component design. Made of strong, ductile iron, for use on a T-slot hold down table in a machine shop. Swivel rocker attached to the body prevents loss. L series features a longer throw.

	Bolt Size	Max Clamping Height	Nominal Dimensions	Recommended Load Limit	Max Torque	Approx. Weight
<b>375L</b>	3/8"	1 1/4"	3 3/4 x 1 1/8 x 1 1/4"	7,000 lbs	43 LB-FT	0.50 lbs
<b>500L</b>	1/2"	2 1/2"	5 3/4 x 1 1/16 x 1 1/2"	8,800 lbs	73 LB-FT	1.39 lbs
<b>625L</b>	5/8"	3 1/2"	6 3/4 x 1 1/4 x 1 3/8"	14,500 lbs	163 LB-FT	2.33 lbs
<b>750L</b>	3/4"	5"	9 x 2 1/8 x 2 1/4"	19,000 lbs	237 LB-FT	4.96 lbs
<b>1000L</b>	1"	5"	11 1/8 x 2 1/8 x 3 3/8"	51,000 lbs	850 LB-FT	12.80 lbs
<b>376S</b>	3/8"	1"	3 x 1 1/8 x 1 1/4"	8,800 lbs	55 LB-FT	0.43 lbs
<b>501S</b>	1/2"	1 3/4"	4 1/4 x 1 7/16 x 1 1/2"	13,200 lbs	110 LB-FT	1.04 lbs
<b>626S</b>	5/8"	2 3/4"	5 1/2 x 1 3/4 x 1 5/8"	19,000 lbs	213 LB-FT	2.10 lbs
<b>751S</b>	3/4"	3 1/2"	7 x 2 1/8 x 2 1/4"	27,600 lbs	345 LB-FT	4.00 lbs
<b>1001S</b>	1"	3"	9 x 2 7/8 x 3 3/8"	67,000 lbs	1,116 LB-FT	10.00 lbs



RiteHite charts are for general guidelines only. Specific values may vary depending on but not limited to bolt size and strength, condition, size and pitch of threads, coefficient of friction between parts and other variable factors.



# Specialty all-steel clamps:

## Hold down clamps



Simply better.

### Compact clamp with open fixing hole, BAS

Space saving compact design. Mounting hole open for M10 / M12 (3/8, 1/2).

	Opening Max.	Throat Depth	Clamping Force	Clamping Arm Length
<b>BAS-C9-4</b> 3101428	88 mm/3.46"	40 mm/1.57"	3600 lbs.	75 mm/2.95"
			Arm for BAS-C9-4	
<b>BAS-C10-6</b> 3101429	97 mm/3.82"	60 mm/2.36"	2700 lbs.	94 mm/3.70"
			Arm for BAS-C10-6	



### BAS-CB compact clamp with closed mounting hole

Space saving compact design. Mounting hole closed for M10 / M12 (3/8, 1/2).

	Opening Max.	Throat Depth	Clamping Force	Clamping Arm Length
<b>BAS-CB9-4</b> 3101428	88 mm/3.46"	40 mm/1.57"	3600 lbs.	75 mm/2.95"
			Arm for BAS-CB9-4	
<b>BAS-CB10-6</b> 3101429	97 mm/3.82"	60 mm/2.36"	2700 lbs.	94 mm/3.70"
			Arm for BAS-CB10-6	

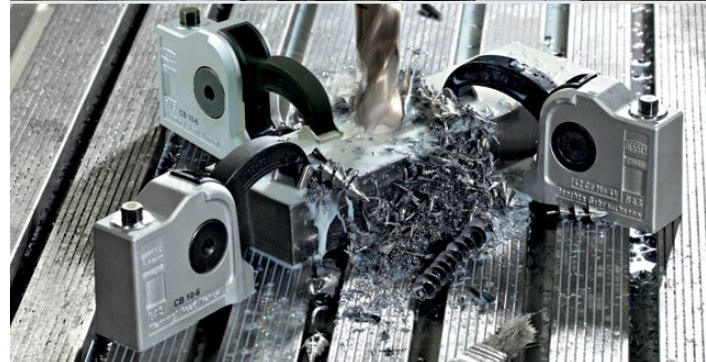
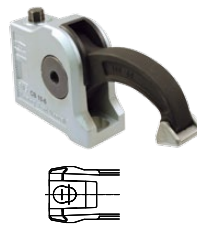

### Base unit BASO

BASO adds an extra 80 mm of height. Stackable up to 10 units. Suitable for all BESSEY® BAS clamps. Mounting hole open for M10 / M12 (3/8, 1/2). Includes socket head screw.

	Opening Max.	Fastening Thread
<b>BASO</b>	80 mm/3.15"	M10

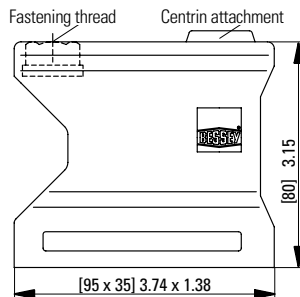

Mounting hole open

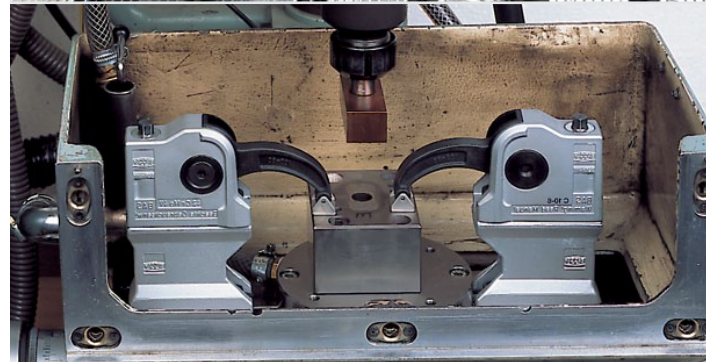
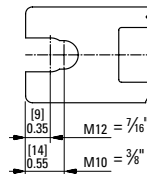

### BASKN wrench with T-bar

T-bar wrench with adjustment tool for M10/M12 (3/8, 1/2) socket head screws. For all BESSEY® BAS clamps.

	Width across flats, allen key	Width across flats, ball head	T-Bar length
<b>BASKN</b>	SW11	SW8-SW10	230 mm/9.06"

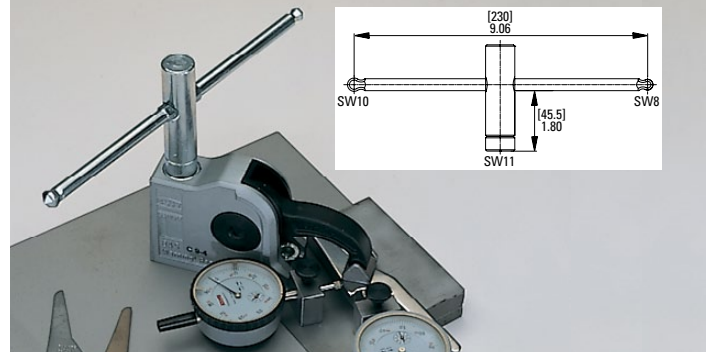
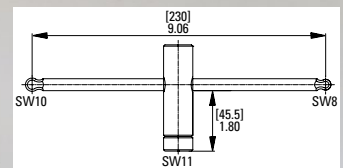

### Service Part

3101431 BAS Arm Tip, set of 4

### Table of dimensions BAS

	Opening Max A	Opening Optimal A1	Throat Depth B	Distance B1	Clamping Arm R	Housing Height [H]	Clamping Force Max. lbs.
BAS-C9-4	88/3.46	42/1.65	40/1.57	36.5/1.44	75/2.95	78/3.07	3600
BAS-C10-6	97/3.82	42/1.65	60/2.36	36.5/1.44	94/3.70	78/3.07	2700
BAS-CB9-4	88/3.46	42/1.65	40/1.57	36.5/1.44	75/2.95	78/3.07	3600
BAS-CB10-6	97/3.82	42/1.65	60/2.36	36.5/1.44	94/3.70	78/3.07	2700
BASO	80/3.15	-	-	-	-	80/3.15	-

