

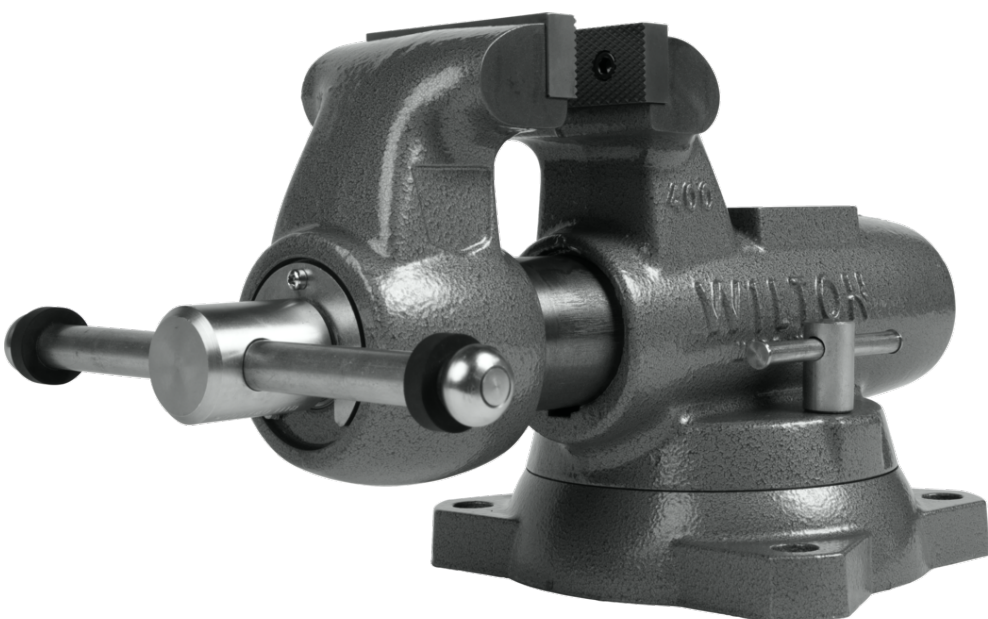

Machinist 4" Jaw Round Channel Vise with Swivel Base

Product Images





Description

Proudly made in the USA, the Machinist round channel vise is designed to handle the most demanding clamping

applications. Unlike most vises that have a fixed center nut, the Machinist vise vise nut is anchored at the rear which provides straight line pull and even pressure resulting in greater durability. The round channel design also allows for a completely enclosed spindle and nut assembly keeping debris out and lubrication in for a lifetime of smooth operation. The Machinist vise is also equipped with main jaws and a machined anvil work surface.

Additional Information

Stock Number	28831
Jaw Width (In.)	4
Number of Mounting Points	4
Opening Capacity Max (In.)	6-1/2
Prop 65	Cancer
Throat Depth (In.)	3-1/2
Type of Base	360 Degree Swivel

